

DETAIL A - TYPICAL COPING DETAIL WITH TILE

*PORCELANOSA STRONGLY RECOMMENDS TO USE A FULL SERVICE WATERPROOFING MEMBRANE IN THIS CIRCUMSTANCE GIVEN THAT WATER INGRESS IS LIKELY TO OCCUR DUE TO NOT HAVING A DRIP IN THE TILE.

1. EXTERIOR STUD WALL: DRY WALL, METAL/WOOD STUDS, SHEATING; BY OTHERS
2. EXTERIOR SOLID WALL: CMU/BRICK MASONRY/REINFORCED CONCRETE; BY OTHERS
3. DAMP-PROOF COARSE (DPC); BY OTHERS; RECOMMENDED OPTIONS: (1) TREMCO EZD AIR 230 FOR AIR/WATER BARRIER (ROLL/LIQUID APPLIED), (2) HENRY BLUESKIN SA FOR AIR/VAPOR/WATER BARRIER (PEEL&STICK), (3) GRADE ICE AND WATER SHIELD FOR WIND DRIVEN RAIN AND ICE DAMS (PEEL&STICK).
4. WINDOW SYSTEM; BY OTHERS
5. FOR CMU WALL: HIT-V-5.8 M8x110 (THREADED ROD) & HIT-SC 16x85 (CHEMICAL ANCHOR SLEEVE) STAINLESS/GALVANISED STEEL SCREW
6. FOR REINFORCED CONCRETE: HRD-U8/10 STAINLESS/GALVANISED STEEL SCREW
7. FOR BRICK MASONRY: HRD-H-10x80 (ANCHORAGE PLUG) & HRD-H-10x80 (ANCHORAGE BOLT) STAINLESS/GALVANISED STEEL SCREW
8. FOR METAL STUD: S-MDSS 5.5x50 STAINLESS STEEL SELF DRILLING SCREW
9. FOR WOOD STUD: 6x50-DIN 571 STAINLESS STEEL SELF DRILLING SCREW
10. ALUMINUM OMEGA PROFILE 20x140MM (3/8"x5 1/2") 3M (118 1/4") LONG
11. SINGLE/DOUBLE THERMAL ISOLATORS (PLASTIC PAD)
12. SINGLE ALUMINUM L-BRACKET; TYP. LENGHT 60MM (2 3/8")
13. DOUBLE ALUMINUM L-BRACKET; TYP. LENGHT 60MM (2 3/8")
14. THERMAL INSULATION SPECIFICALLY ENGINEERED FOR CAVITY WALL APPLICATIONS; BY OTHERS; RECOMMENDED OPTIONS: (1) ROXUL CAVITYROCK DD (STONE WOOL), IS A DUAL DENSITY INSULATION BOARD WITH A HIGH-DENSITY OUTER LAYER, (2) THERMAX, IS A GLASS-FIBER-REINFORCED POLYISOCYANURATE FOAM CORE FACED WITH THERMOSEER-COATED ALUMINUM ON ONE SIDE AND ALUMINUM ON THE OTHER.
15. FOR L-BRACKET/PROFILE: LT SELF DRILLING SCREW
16. POWDER COATED (BLACK) ALUMINUM T-PROFILE, 100x60x2.7MM (3 15/16"x2 3/8"x1 1/8"), 3M (118 1/4") LONG
17. POWDER COATED (BLACK) ALUMINUM L-PROFILE, 40x60x2.7MM (1 5/8"x2 3/8"x1 1/8"), 3M (118 1/4") LONG
18. FOR FIXING CLIP/PROFILE: STAINLESS STEEL SELF DRILLING SCREW
19. INVISIBLE/VISIBLE CENTRAL STAINLESS STEEL FIXING PLATE, TYP. 5MM (3/16") JOINT, ALSO AVAILABLE FOR 8MM (5/16")
20. INVISIBLE/VISIBLE LATERAL STAINLESS STEEL FIXING PLATE, TYP. 5MM (3/16") JOINT, ALSO AVAILABLE FOR 8MM (5/16")
21. INVISIBLE/VISIBLE START/END FIXING PLATE
22. INVISIBLE/VISIBLE STAGGERED STAINLESS STEEL FIXING PLATE, TYP. 5MM (3/16") JOINT, ALSO AVAILABLE FOR 8MM (5/16")
23. BLACK POLYURETHANE STRUCTURAL SILICON-P-404
24. PORCELAIN TILE, PORCELANOSA, VENIS OR URBATEK COLLECTION.
25. ALUMINUM FLASHING; BY OTHERS

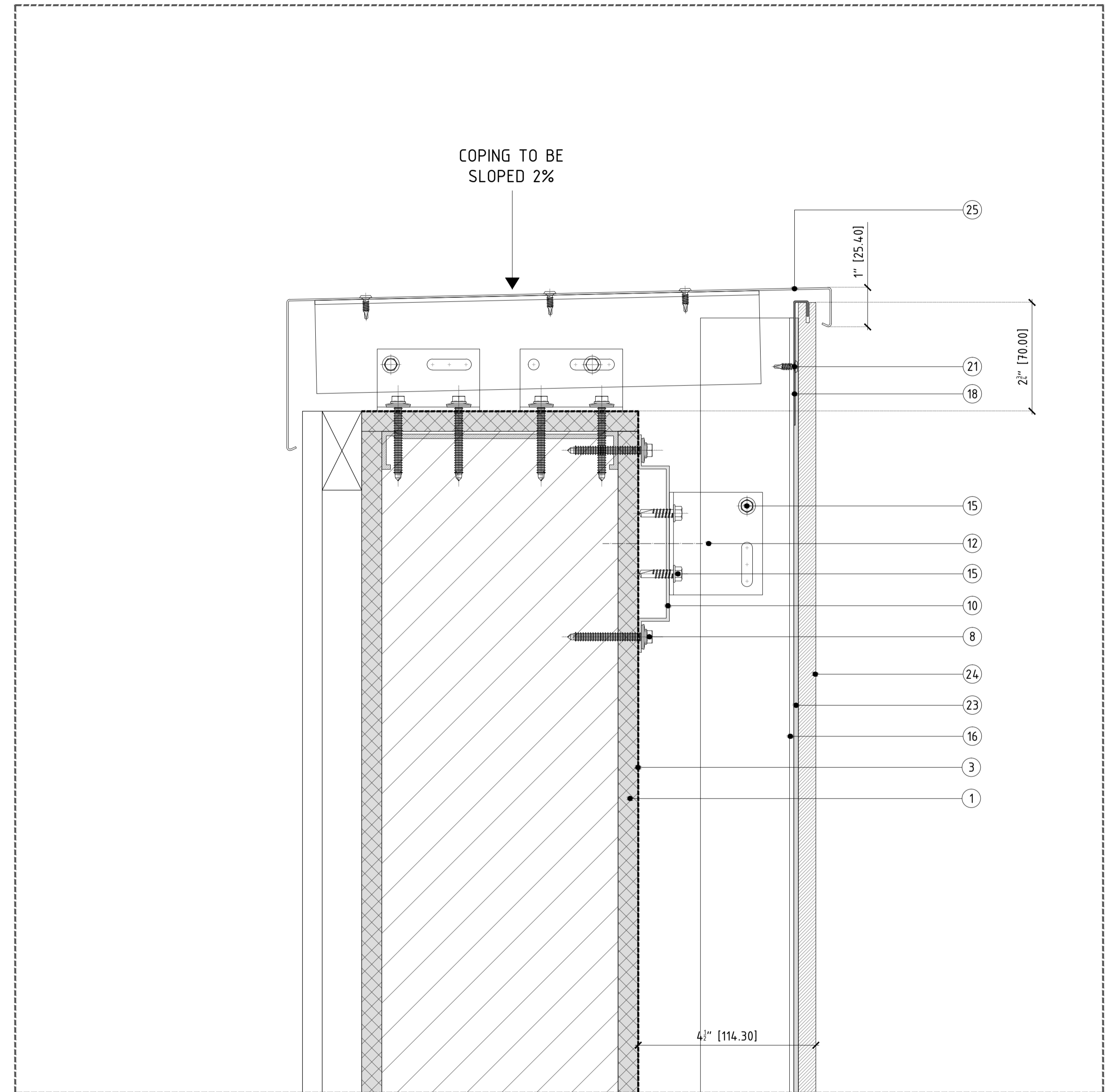

DETAIL B - TYPICAL COPING DETAIL WITH ALUMINUM FLASHING

revision		important note		shop drawings review		drawing title		drawing no.		revision		
A		UNLESS IN CIRCUMSTANCES SHOWN DIMENSIONS BE SCALED FROM THIS DRAWING. "IF IN DOUBT ASK" COPYRIGHT AND DISTRIBUTION TO THIRD PARTIES PROHIBITED. ALL DIMENSIONS TO BE REVERSED UNLESS OTHERWISE NOTED. THIS DRAWING IS TO BE READ IN CONJUNCTION WITH ALL OTHER RELEVANT DRAWINGS. ANY DISCREPANCIES TO BE BROUGHT TO THE ATTENTION OF THE RELEVANT ENGINEER.		drawing reviewed by:		VFS - PORCELAIN TILE CLADDING COPING DETAILS		112		A		
B	15/01	IV/JC	drawing reviewed by:		architect		status		reference		scale	
C			status A status B status C date reviewed		architect		status		reference		scale	
D					architect		status		reference		scale	

PORCELANOSA USA

BANK OF DETAILS

architect

status

reference

drawn

checked

scale

HALF SIZE @Arch D

3"=1'-0" @Arch B